

SyntGo

(code 121700)

PORTABLE TISSUE DISSOCIATOR *(based on MMII Technology)*



**WIRELESS DISSOCIATOR
TO RUN ALL KIND OF MEDICONS
TO OBTAIN CELL SUSPENSION
FROM SOLID TISSUE**



syntec
www.syntec-international.com

SyntGo

(code 121700)

Technical Features

SyntGo is a CE portable wireless lab device to do sample preparation for flow cytometry analysis. It can be used in combination with all types of Medicons consumables.

- It has a programmable HMI where to set the running time, start and stop;
- Color display indicating the time set and the battery level;
- Batteries (not included) are AA (2 x 1,5 V)
- It works at the same constant rpm and torque of Medimachine (82 rpm; 400 mNm)

Working condition:

- Temperature: +5 to + 45 °C
- Humidity: < 90%
- Altitude: unlimited

Storage:

- Dry place
- Temperature: 0 to + 50 °C

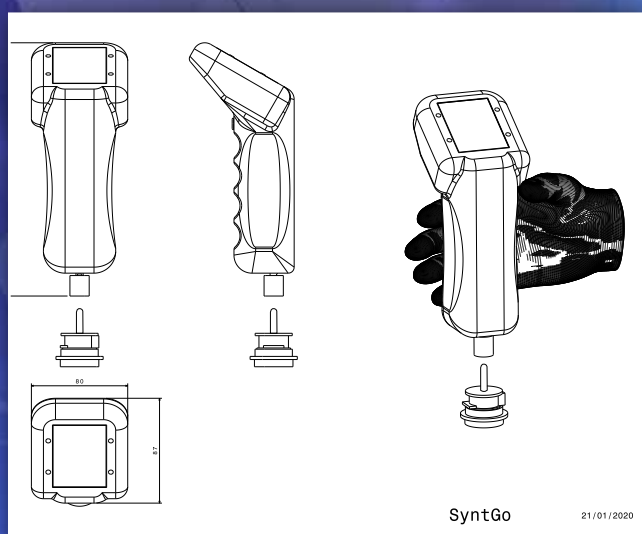

Operative headquarters:
via Marco Polo, 28 - 10090 **Bruino (TO)** Italy
tel. +39.011.9049381 - fax +39.011.9055288
info@ctsv.biz - www.ctsv.biz